

THERMOWELL DIMENSIONS

DIMENSIONS FOR STANDARD VAN STONE THERMOWELL DESIGNS

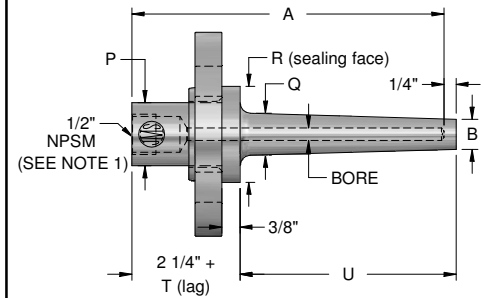
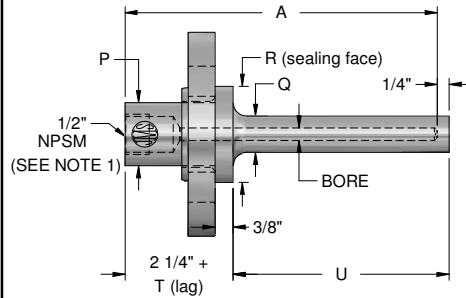
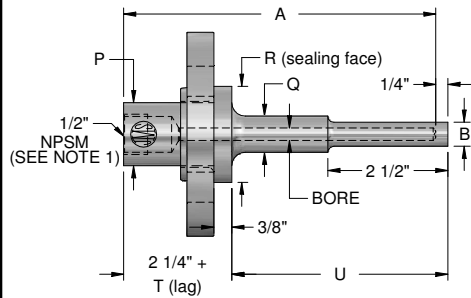

STEP SHANK				
SIZE	BORE	U	Q	B
1"	.260"	$\leq 2 \frac{1}{2}"$.750"	.750"
		$> 2 \frac{1}{2}"$.750"	.500"
	.385"	N/A	N/A	N/A
1 1/2"	.260"	$\leq 2 \frac{1}{2}"$.750"	.750"
		$> 2 \frac{1}{2}"$.875"	.500"
	.385"	N/A	N/A	N/A
2"	.260"	$\leq 2 \frac{1}{2}"$.750"	.750"
		$> 2 \frac{1}{2}"$	1.250"	.875"
	.385"	N/A	N/A	N/A

STRAIGHT SHANK			
SIZE	BORE	U	Q
1"	.260"	ALL	.750"
	.385"		.875"
1 1/2"	.260"		.750"
	.385"		.875"
2"	.260"		.750"
	.385"		1.125"

TAPERED SHANK				
SIZE	BORE	U	Q	B
1"	.260"	ALL	.875"	.625"
	.385"		.875"	.766"
1 1/2"	.260"		1.063"	.625"
	.385"		1.063"	.766"
2"	.260"		1.375"	.875"
	.385"		1.375"	1.000"

NOTES:

- 1) - NPT THREAD TYPE IS OPTIONAL
- 2) - A DIMENSION IS THE BORE DEPTH AND MATCHING SPRING LOADED SENSOR IMMERSION LENGTH.